

LEGEND

- ASPHALT PAVEMENT
- CONCRETE PAVEMENT
- ARTIFICIAL TURF

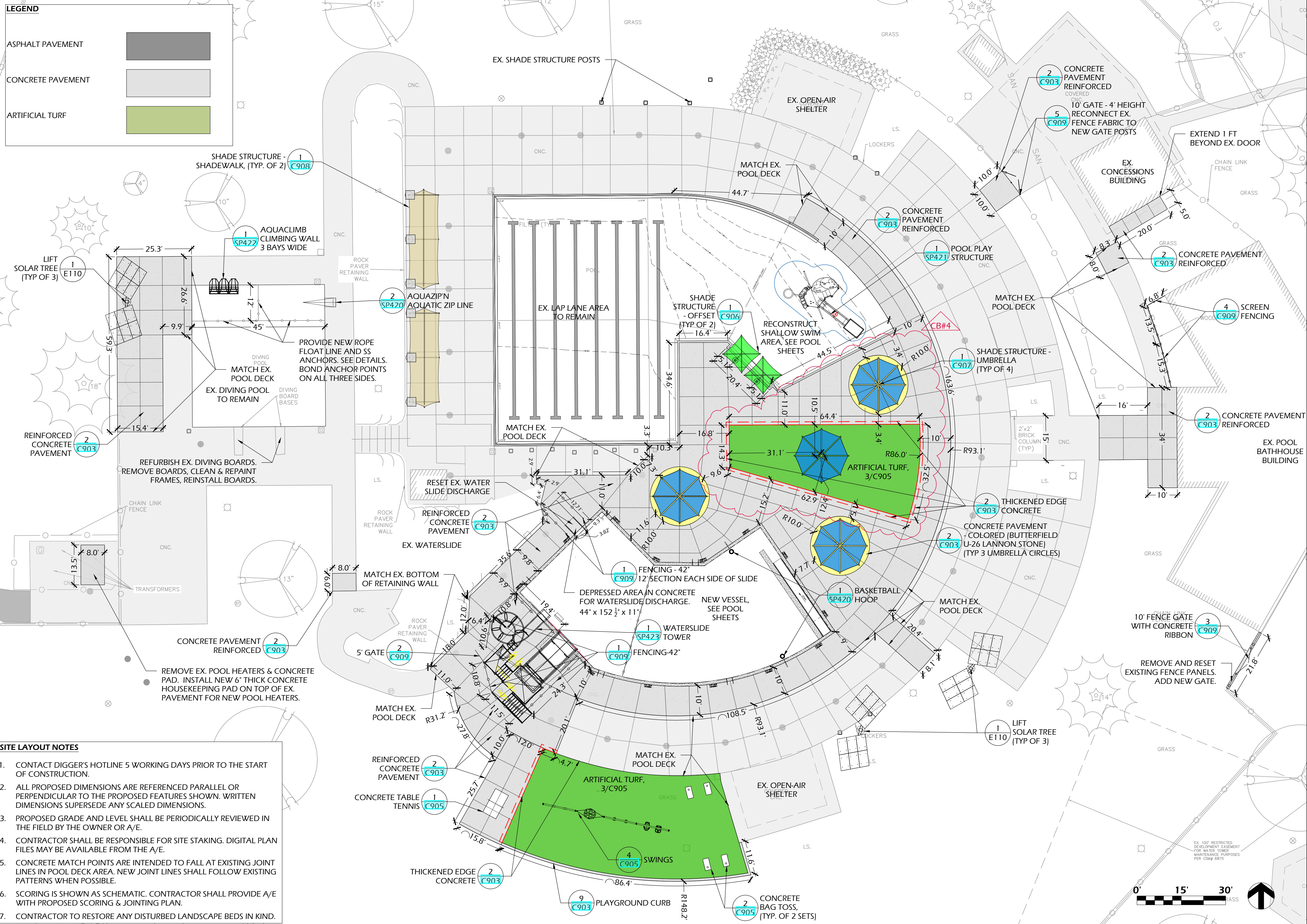

- SITE LAYOUT NOTES**
- CONTACT DIGGER'S HOTLINE 5 WORKING DAYS PRIOR TO THE START OF CONSTRUCTION.
 - ALL PROPOSED DIMENSIONS ARE REFERENCED PARALLEL OR PERPENDICULAR TO THE PROPOSED FEATURES SHOWN. WRITTEN DIMENSIONS SUPERSEDE ANY SCALED DIMENSIONS.
 - PROPOSED GRADE AND LEVEL SHALL BE PERIODICALLY REVIEWED IN THE FIELD BY THE OWNER OR A/E.
 - CONTRACTOR SHALL BE RESPONSIBLE FOR SITE STAKING. DIGITAL PLAN FILES MAY BE AVAILABLE FROM THE A/E.
 - CONCRETE MATCH POINTS ARE INTENDED TO FALL AT EXISTING JOINT LINES IN POOL DECK AREA. NEW JOINT LINES SHALL FOLLOW EXISTING PATTERNS WHEN POSSIBLE.
 - SCORING IS SHOWN AS SCHEMATIC. CONTRACTOR SHALL PROVIDE A/E WITH PROPOSED SCORING & JOINTING PLAN.
 - CONTRACTOR TO RESTORE ANY DISTURBED LANDSCAPE BEDS IN KIND.

PARKITECTURE + PLANNING
 901 Deming Way, Suite 201
 Madison, WI 53717
 608.203.8203

ONE DESIGN & ENGINEERING
 Est. 2020
 202 Ash St, Cambridge, WI 53523 • 608.577.0443 • www.onedesign.com

SUN PRAIRIE AQUATIC CENTER REDEVELOPMENT
 920 LINNERUD DRIVE
 SUN PRAIRIE, WI 53590

SITE LAYOUT PLAN - POOL DECK

Project Name: SUN PRAIRIE AQUATIC CENTER REDEVELOPMENT
 920 LINNERUD DRIVE
 SUN PRAIRIE, WI 53590

Revisions: 11/19/2025 CB #4

Project #: 24.030
 Issued For: Construction
 Date: 8/18/2025

Sheet Number: C210

File: V:\24.030_Sun_Prairie_FAC_CDs\CAD\P-SP.dwg Layout: C210 User: KatieM Plotted: Nov 19, 2025 11:13am